



# Getting started Self-Guided Tour

## The Maughan Library\*

\*pronounced 'Mawn like Lawn'

Simplified  
version

# Contents

- Introduction to Libraries & Collections.
- Health and safety.
- Brief history of the building.
- The fundamentals.
- What is in the Maughan Library?
- Layout of the Maughan Library.
- Getting Started Tour.
- Study spaces and zones.
- “Explore”. Café, Wellbeing space, & more.
- Special Collections and Archives.
- Workshops and 1:1 Appointments.
- Subject-specific information.

Scroll through the guide OR Click on a title to jump to a section

# Introduction to Libraries and Collections at King's

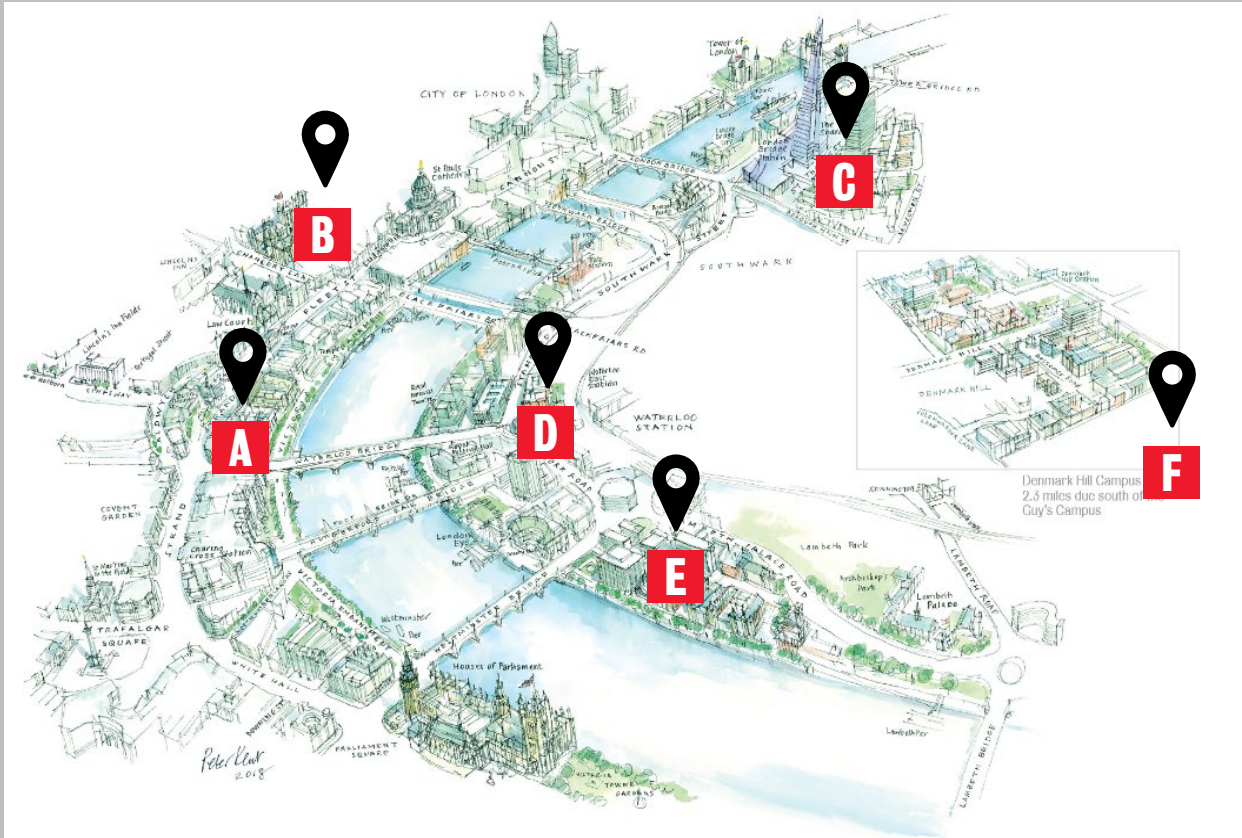

- A – Strand** – Archives (3<sup>rd</sup> Floor)
- B – Strand** – Maughan + Special Collections Libraries
- C – Guy's** – New Hunt's House and Wills Libraries
- D – Waterloo** – Franklin-Wilkins Library
- E – St Thomas** - St Thomas' House Library
- F – Denmark Hill** – Weston Education Centre (WEC) + Institute of Psychiatry, Psychology & Neuroscience (IoPPN) Libraries

There are seven (7) libraries at King's.

There is at least one library at each campus.

You can access all the libraries with your King's ID card .

You can see the collections at each site on the [Map of subject collections](#) we put together.

The Strand Campus library is the Maughan Library (pronounced “mawn” like “lawn”).



## Health and Safety

If the alarm sounds, follow the instructions given on the tannoy announcement.



If you are told to get yourself to the nearest fire exit, they are marked with clear fire exit signs.

First aid can be provided by Security Staff at the entrance of the Maughan Library.

Keep your valuables safe, do not leave them unattended.





## Brief history of the building

The roots of building lie in a house built on this site in 1232 by Henry III as a refuge for Jewish people who had forcibly converted to Christianity. Henry III had forced them to choose between converting or being thrown out of Henry's kingdom.

Later, on the same site, the Public Records Office was built.

This is the building you see today.

It was built between 1856 and 1898 and is now a Grade II\* (Grade 2 Star) listed building, meaning it is strongly protected by the law as a beautiful building.

It is the first purpose-built fire-proof building. This was done as a reaction to the Palace of Westminster not far from here burning down in 1836.

King's got the building in the late 1990s and turned it into the library it is today.

The library was named in honour of Sir Deryck Maughan, a previous student at the university.

To find out more join one of our [historical tours of the Maughan Library](#).

# The fundamentals

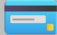
Your King's ID card is your library card. 

Tap your card on the gates to access the library.



There is Wi-Fi throughout library. The Wi-Fi is called Eduroam.

You use your King's ID (i.e. K1234567) with @kcl.ac.uk (so K1234567@kcl.ac.uk) at the end and your usual password to log in to the Eduroam Wi-Fi.



For access to computers, printing, and logging into e-resources you also use your King's ID (i.e. K1234567) and usual password.

You can print your documents by using the “Follow-me” printing option on any King's computer. Your document can be released from any printer in any of the libraries or computer rooms.





## What is in the Maughan Library?









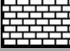

The collections at the Maughan Library support the teaching and research interests of Humanities, Social Sciences, Law, and Physical Sciences including:

- Business studies.
- Classics.
- Computer science.
- Cultural & creative industries.
- Digital culture & Technology.
- English.
- European Studies.
- Film Studies.
- French.
- Geography.
- German.
- History.
- Law.
- Mathematics.
- Middle East & Mediterranean Studies.
- Music.
- Philosophy.
- Politics.
- Physics.
- Spanish, Portuguese & Latin-American Studies.
- Theology & Religious Studies.
- War Studies.

# Layout of the Maughan Library – Part 1/3

The Maughan Library is comprised of:

- four (4) main floors (called -1, G, 1, 2),
- three mezzanine floors (called GM, 1M, 2M),
- plus the five (5) Clock Tower floors (called T1-T5 Postgraduate study spaces).

Collections	Floors
 [Science journals]	2 + 2M
 [Science books]	2 + 2M
 [Humanities books] Folio & Outside	2M
 [Humanities books] E-Z	2 + 2M
 [Humanities books] A-D	1 + 1M
 [Law journals]	1 + 1M
 [Law books]	1 + 1M
 [Humanities journals]	GM
 Music, Film & Multimedia	G + GM
 [Books Store]	-1



Mezzanines are in-between floors that can be reached using the lifts or staircases in the rooms below them. Lookout for the mezzanine stair icon on the floor plans.

Our collections are organised across these floors and clearly marked on the floor plans inside the library.

You can follow the collections inside the library by colour and patterns.

These colours and patterns correspond to the collection name of a specific subject or area of study.



## Layout of the Maughan Library – Part 2/3

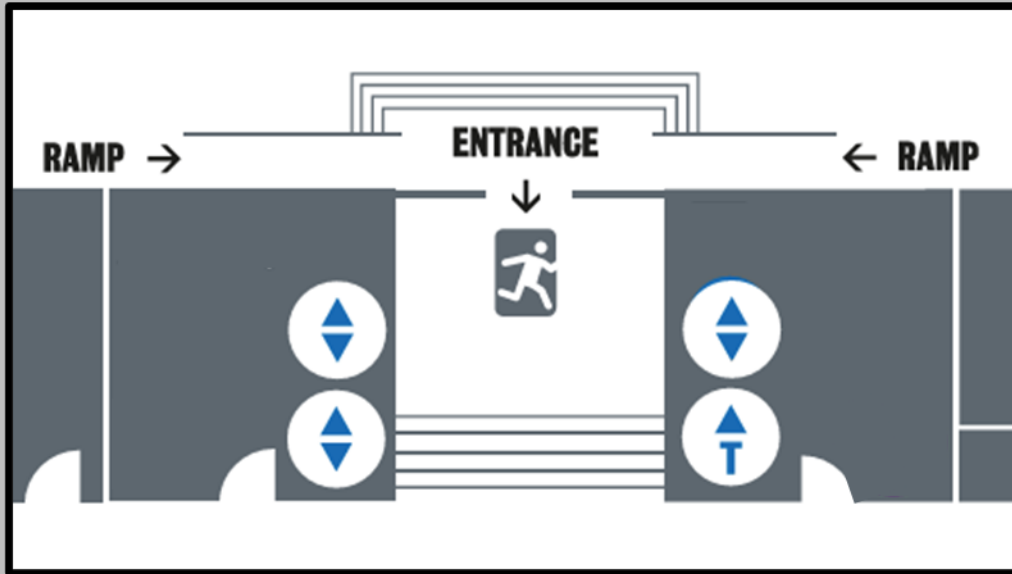

The main lifts are in the two lift lobbies on each side of the entrance to the Maughan Library.

The lifts in the Maughan can be a bit complicated to use as not all lifts go to all floors.

Each lift has a clear label to tell you where it goes.

“T – Lift” or Lift 3 is the only one that can access the five (5) Clock Tower floors (T1-T5 Postgraduate study spaces).

For more information on accessibility check the [library disability support webpage](#).

## Layout of the Maughan Library – Part 3/3

Toilets are on each floor near the so-called West stairs.

Water fountains are next to the toilets.

The main stairs (East and West stairs) are at either end of the building.

You can access all the main floors (-1, G, 1, 2) with these stairs.

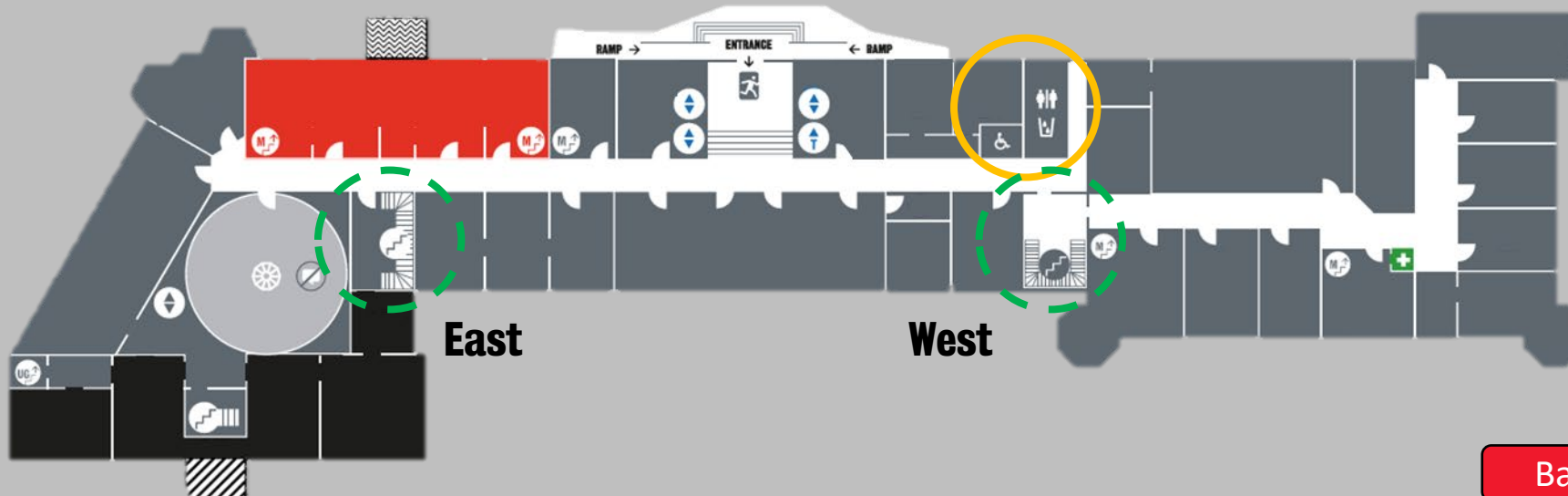

# Getting Started Tour Map

Click on a number to see the information about the service or facility

1. [Information Point](#)
2. [IT Tech Bar & LibAnswers + LibChat PC](#)
3. [Self-Service Kiosk](#)
4. [Book returns machine](#)
5. [Short-Loan books & reservations collections area](#)
6. [Library Search computer](#)
7. [Laptop loan cabinet](#)
8. [Print Copy Scan](#)
9. [Chargebox](#)
10. [Round Reading Room](#)
11. [Student computer room](#)
12. [Group study room](#)

## Ground Floor (G)

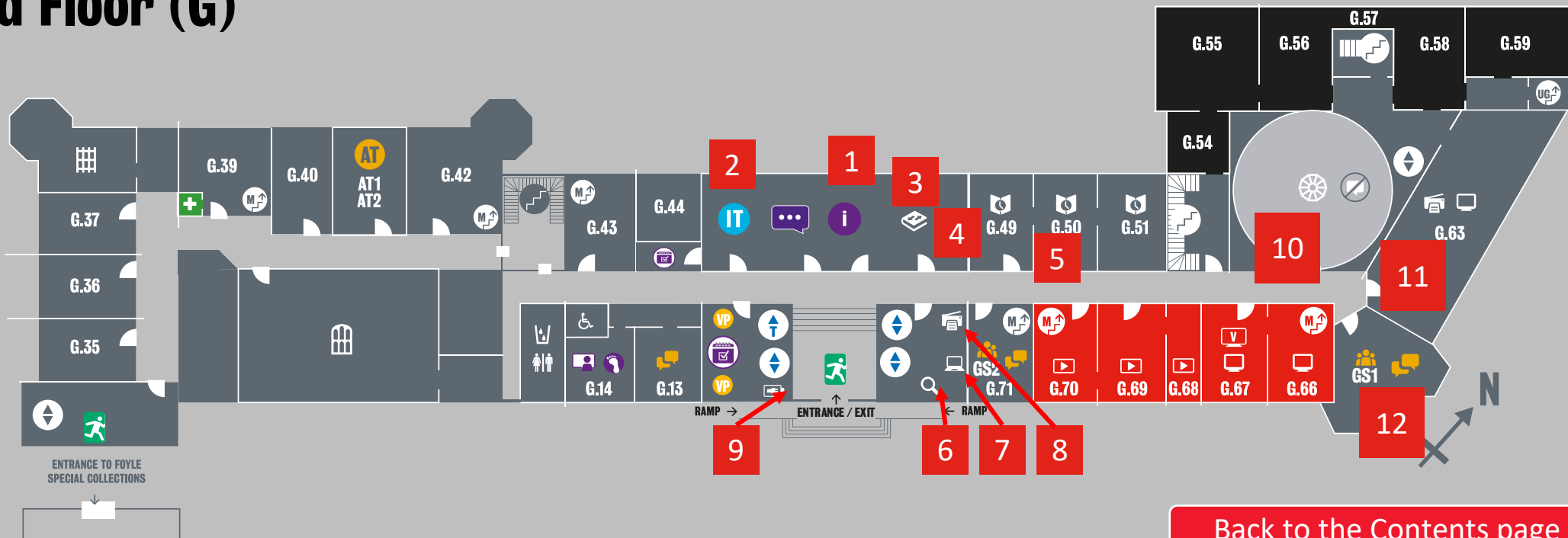



## Library Information Point

The Maughan Library is staffed with librarians seven (7) days a week.

-  On Monday to Friday, staff are in the library from 09.00–19.00 and on the weekend 10.00-18.00.

The library building is open longer with security staff present after the librarians leave.

-  You can use the Maughan Library until 01.00 in Semester 1 and 24/7 in Semester 2.



Library staff on the Library Information Point and in between the shelves can be recognised by their purple lanyards or purple shirts.

The shirts and the lanyards have the King's logo on them and clearly say: "Libraries & Collections".



## Tech Bar

If you have any IT queries pay a visit to the **Tech Bar** to the left of the Library Information Point.

The IT staff at the Tech Bar can assist you with questions about:

- personal printing 🖨️
- your King's IT account 🔑 and
- using IT Services like the Wi-Fi 🌐

You also can contact the King's Service Desk directly. They are available 24/7, 365 days per year.



## LibAnswers FAQs + LibChat PCs

There are special PCs near the IT Tech bar and in the lift lobbies on the First (1) and Second (2) floors of the Maughan Library.

These special PCs have our collection of Frequently Asked Questions (LibAnswers FAQ) on them as well as a button to start a library chat (LibChat) with a librarian at any time.

They are clearly marked with a frame around the screen.

You can use these to contact a librarian directly 24 hours a day, 7 days a week.

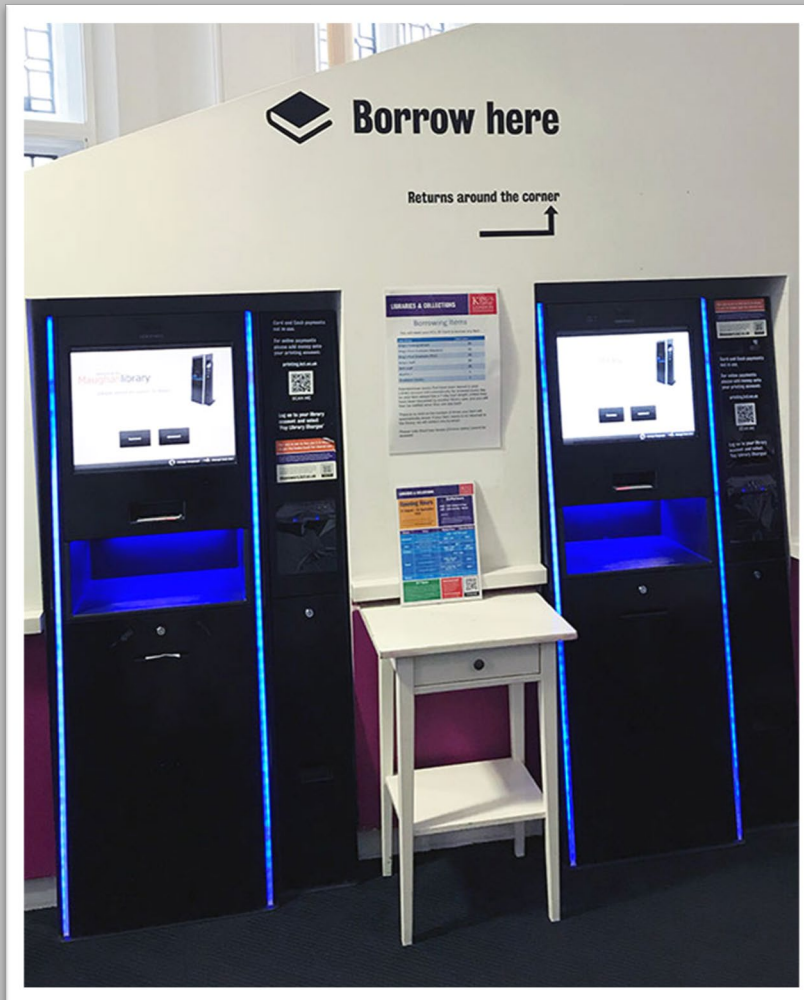

## Self-service kiosks

Once you have found a book you want to borrow, use one of the self-service machines and your King's ID Card to borrow it. 

You can find them on the Ground Floor and in the First (1) and Second (2) floor lift lobbies.

## Auto-renewals

Books you borrowed and are approaching their due date will automatically renew themselves on your account. We have set our library management system to work that way. They will not renew, if someone else needs them. We will email you if that is the case.

**!NOTE!** Auto-renewal does not include items in the 24-hr loans category, 72-hr laptop loans, and inter-library loans (books we got you from a different library).

Find out more about auto-renewals including exceptions on our dedicated [LibAnswers webpage](#).







## Book returns machine

To return items at the Maughan Library please use the book returns machine around the back of the self-service kiosks.

Place one item in at a time.

Wait for a green light before you place your next item on the conveyer belt.

You do not need your King's ID Card to return items.  

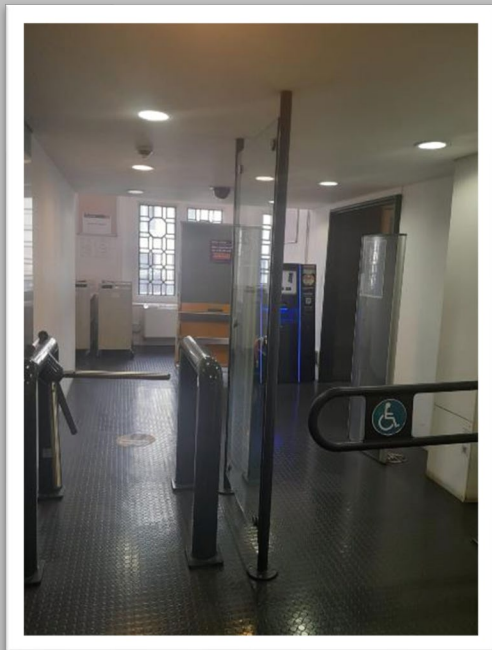

## Short loans collection

In Rooms G.49 – G.51 on the Ground floor you will find the 24-hr (Short) loans collection and the Reservations shelf.

The 24-hr (Short) loans collection contains items that have been identified by lecturers as being in high demand.

This means they are not renewable, and you will be charged a higher rate if they are not returned on time.

## Reservations

The Reservations shelf is also in this area.

If you reserved or requested an item - and we emailed you that it is ready - you can find it here.

The items are ordered by the first three letters of your surname and last four digits of your King's ID card number [i.e. ABC-1234].



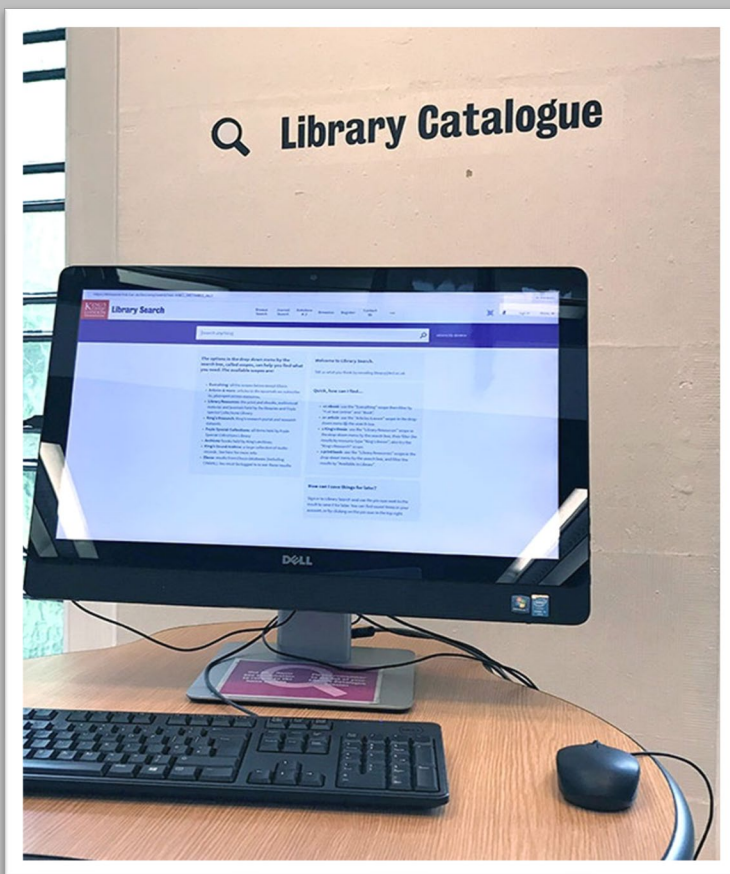

## Library Search PCs

To find a book, use one of the Library Search PCs found in the lift lobbies on each floor.

The area is marked with the words: 'Library Catalogue'.

Once you have found your book on the Library Search PC, note down its classmark and location. A classmark is a code made up of letters and numbers we have given all the books to decide which book goes where. They look like this: PN1995.F748 HUS .

Then use the directions on the [floor plans](#) to get to the book.

A member of the library staff at the Library Information Point can explain this to you more if you need help.







## Laptop Loan Cabinets

You can also borrow a laptop from us. 

To borrow a laptop, use your King's ID card at the laptop loan cabinets across from the Library Information Point. 

You can borrow the laptop for 72 hours (3 days). You cannot renew a laptop loan and have to return it within 72 hours.

## Print Copy Scan

There are personal printers on every floor of the Maughan Library 🖨️.

The printers can print, copy, and scan items to your personal email.

Send your documents to the 'Follow Me Printing'-printer and they can be released from any working printer across King's through use of your King's ID card. 📄

The first time you use a printer you will need to register on it.

To register, use your King's ID card on the printer and enter your King's login details (i.e. K1234567 + your password) when asked. 📄

King's IT has a [quick guide to using the print, copy, scan machines.](#)





## Chargebox

You can make use of the so-called Chargeboxes at the Maughan Library.

They support most chargers and securely charge your device for free.

Each cabinet has its own key.

Make sure your devices is on silent before you put it in the Chargebox. 📵



## Round Reading Room

The Round Reading Room is on the Ground Floor. It is a very famous space that many people want to see.

It has the Humanities Reference collection in it.

This room is mentioned in the book *The Da Vinci Code*.

The room design is based on the British Museum reading room.

**Tip:** with limited spaces, arrive early to get a seat.



## Student computer room

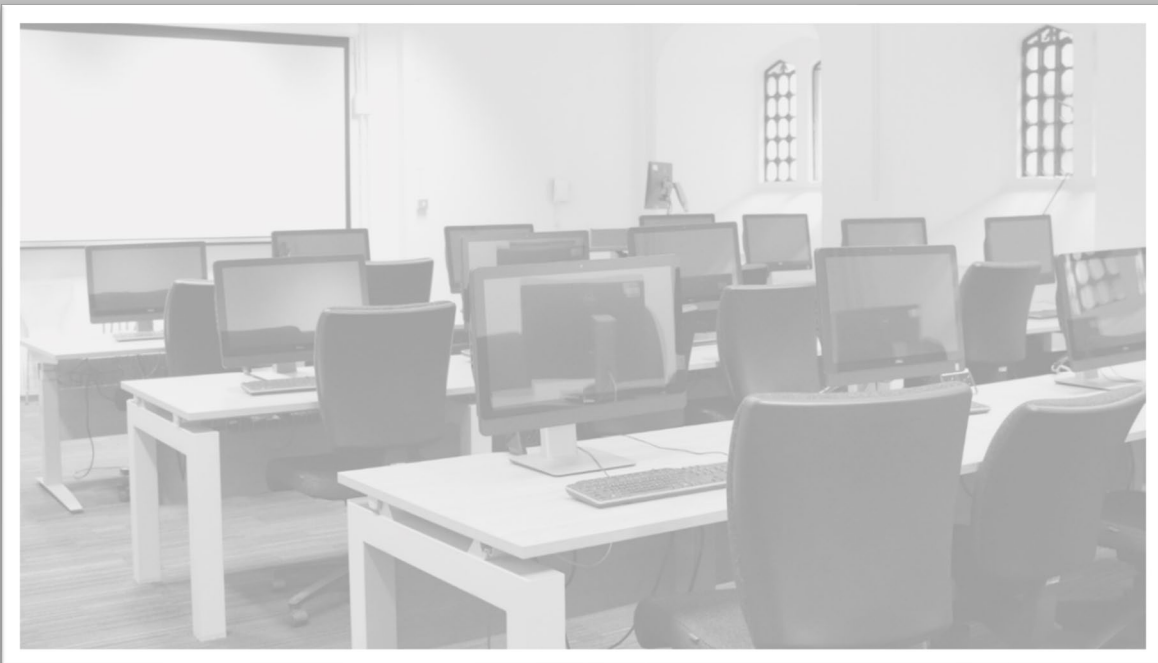

The Maughan Library has more than one computer room you can use  .

To use a free computer, you just need your King's login details (i.e. K1234567 + your password).

You can find an available PC using the [PC-free](#) system.

## Bookable group study rooms/desks



There Maughan Library has five (5) group study rooms to use. 🧑🧑🧑

They are all clearly marked with the group study room symbol.

They can be booked for groups of 3 – 12 people.

We have written instructions on [how to book a group study room](#).

# Plug & Play Screens

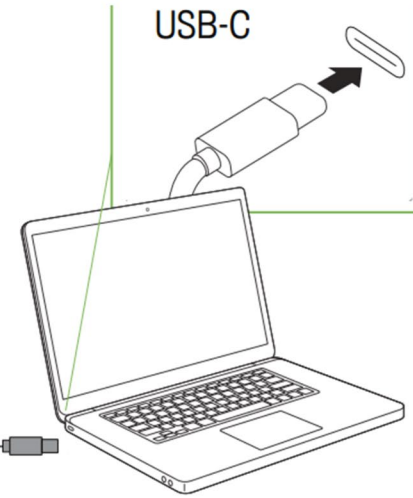

In the library space, you can also find so called Plug & Play Screens.

They allow you to connect your own device for extra screen space.

Plug the USB-C cable provided into your device as shown to use the desk's monitor, keyboard, and mouse.





## Study Spaces

There are many study places and reading spots in the Maughan Library.

They can suit all study styles, and we encourage you to try them all out.

That way you can find what works best for you.

Some spaces are desks with power sockets, others have computers, and a third category has Plug & Play screens that allow you to connect your own device for extra screen space.

Postgraduate students have access to the Clock Tower floors (T1-T5 Postgraduate study spaces).

We have a guide for all Postgraduate spaces on our website.

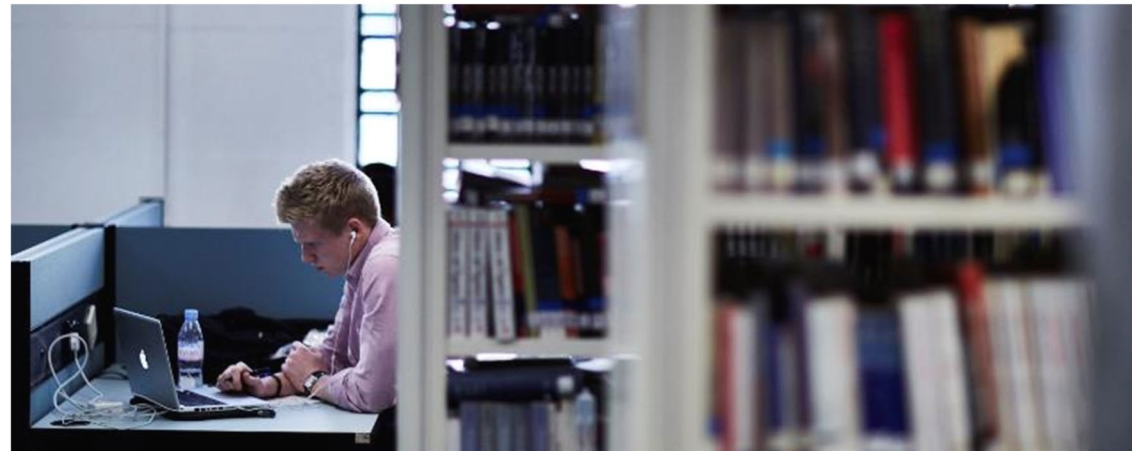



## Quiet

- Please keep any conversations brief and low-volume (whispering level), including no talking on your phone.
- You can consume lidded drinks and cold food.



## Silent

- No talking in silent areas (including on your phone) and you should keep other noise to a minimum
- Please move to another zone if you need to talk, eat or undertake other tasks that may impact others' opportunity to study in silence.
- You can consume lidded drinks only, no food permitted.



## Discuss

- You can work together and use your phone.
- You can consume lidded drinks and cold food.

## Find your Zone

There are three (3) different types of zone in all our libraries.

They are colour-coded and marked with symbols on the Floor Plans as well as on the walls inside the libraries.

Choose a zone that suits your study needs and be mindful of others studying around you.

We have a Noise Line you can text, if a zone is too loud.

If you text the Noise Line, we will respond as soon as possible to investigate.

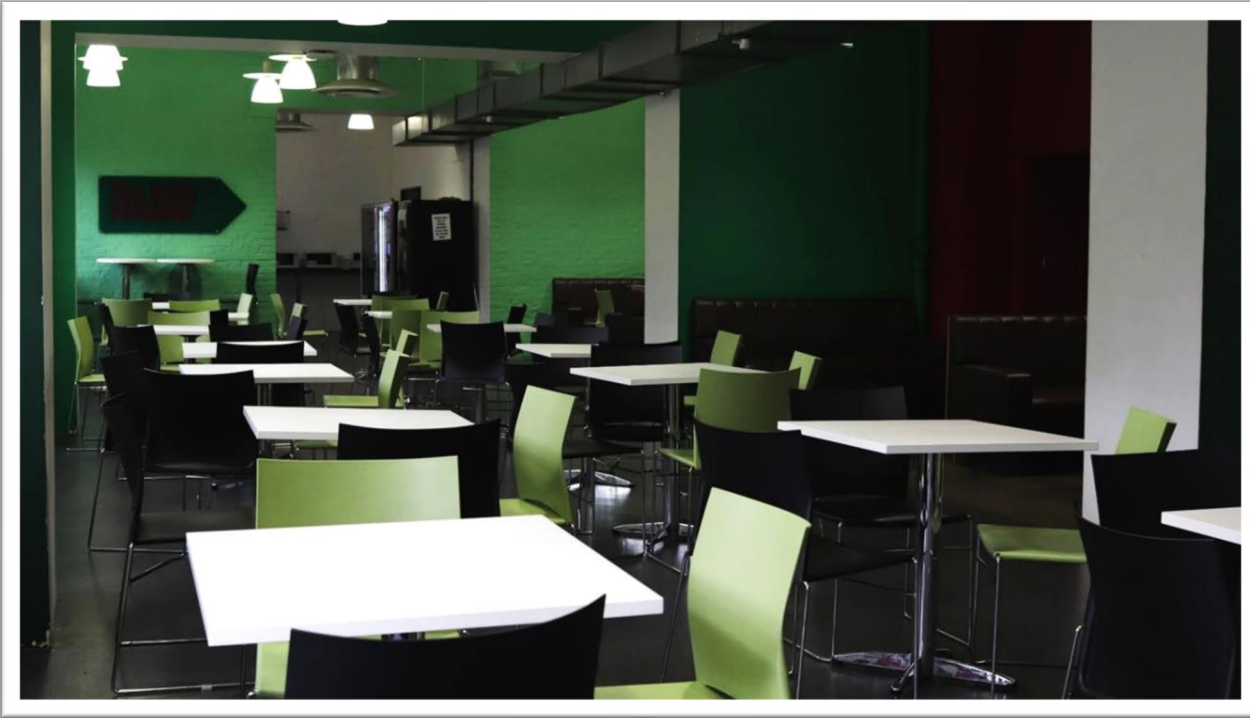

## Explore... The Rolls Café

Available downstairs on Floor -1.

 Open **Monday- Friday** 10.00 – 16.30 (during term-time).

The Rolls Café has a selection of sandwiches, cakes, snacks, and freshly made barista coffee.

Microwaves and vending machines are available at the back of the room.

The Rolls Café is one of many [King's Food and KCLSU options](#) for food and drink on campus.

## Explore ... The Wellbeing Room



If you're feeling low, recharge your own batteries in the Wellbeing Room.

It is on the Second (2) floor in room 2.24.

This room is for resting, quiet conversations, reading, crafting, and colouring.

Take time away from your device here or have it on silent.

We have set up a collection of wellbeing books in this room for you to use.



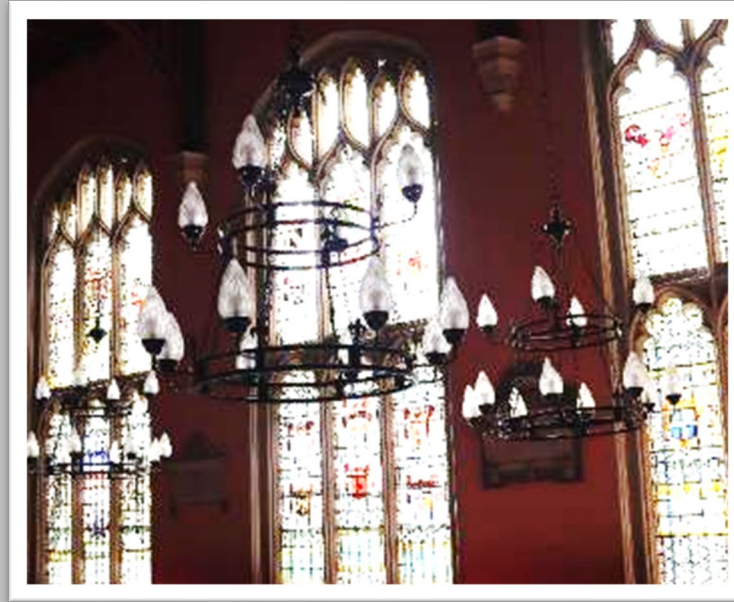

## Explore ... The History of the building

Take a look at our historic rooms on the Ground floor of the building.

You can admire the mosaic floor and the stained-glass windows in the so-called Weston Room when the library is open.

Look up when you exit the library – the ceiling is quite special.

Join one of our [Historical tours of the Maughan Library](#) to learn even more.





## Explore ... The Garden

Outside the Maughan Library there is garden area, a great place to relax if the weather is good.

We also have two (2) bike sheds. 🚲

One is near the garden area and the other bike shed can be found at the back of the library.

The entrance to the second bike shed is behind the smaller gate on Chancery Lane.

This second bike shed is more secure and is accessible using your King's ID card. 🛖





## Special Collections and Archives

As well as the main collections we also have a Special Collections Library and Archives. They keep hold of the very expensive and very old items.

The so-called Foyle Special Collections Library is inside the Maughan Library.

The Archives are inside the Strand Building on the Strand.

They hold a unique, very important and growing range of archival and printed sources.

[kcl.ac.uk/library/collections](https://kcl.ac.uk/library/collections)



## Workshops

We have different support options available depending on where you are at with your studies.

**KLaSS (King's Learning and Skills Service)** has online training so you can succeed in your studies and research. You can find KLaSS on Keats, the same King's online learning platform that has your modules on it.



We run workshops every month to help you with finding and evaluating relevant literature for your degree.

You can sign-up for these via the 'Library Workshops, Drop-ins and 1-1s' tab on the **Library Guide** for your degree.

Workshops are either online via the Microsoft Teams app or held in-person on campus.

## 1:1 Appointments

If you need more help, you can book a 1-1 appointment with a librarian using Microsoft Teams.

They are available Monday to Friday.

You can sign-up for these 30-minute sessions to get help with accessing online resources for example. Use the 'Library Workshops, Drop-ins and 1-1s' tab on the **Library Guide** for your degree to sign up.





# Subject-specific information

- [Classics](#)
- [Comparative Literature](#)
- [Culture, Media and Creative Industries](#)
- [Digital Humanities](#)
- [English](#)
- [Film Studies](#)
- [French](#)
- [German](#)
- [History](#)
- [Law](#)
- [Music](#)
- [Music Scores, Films & Multimedia](#)
- [Philosophy](#)
- [Political Economy](#)
- [Science](#)
- [Spanish, Portuguese & Latin American Studies](#)
- [Theology & Religious Studies](#)

This browsing guide shows the classmarks and room numbers for all the subject classmarks at the Maughan Library.

# Browsing guide

## The Maughan Library



Remember to check the collection name [ *in brackets* ] on the catalogue – items with the same Classmark can be in different parts of the library depending on the collection they are in, e.g. [Law books] on Floor 1, [Law Short-loan] on the Ground Floor or [Law – book Store] on Floor -1 etc.

### [Humanities books] A-D

Subject	Classmark	Room(s)
General Works	A	1.58
Philosophy, Psychology, Ethics	B – BJ	1.57 – 1.59
Theology & Religious Studies	BL – BX	1.59 – 1.54, 1M.54 – 1M.59
Auxiliary sciences of History	C	1.66
History: General and Old World	D – DX	1.66 – 1.71, 1M.66 – 1M.72, 1.13 – 1.14, 1M.13 – 1M.14

### [Humanities books] E-Z

History: Americas	E – F	2M.13 – 2M.16, 2.13
Geography, Anthropology	G	2.14
Social Sciences	H – HX	2.14 – 2.13, 2.43 – 2.51
Political Sciences	J – JV	2.48 – 2.46
Education	L	2.46
Music (books)	M	2.46 – 2.45
Fine Arts	N	2.45 – 2.44
Linguistics	P	2.44
Latin & Greek (Language / Literature)	PA	2M.43 – 2M.51, 2.56 – 2.54
Modern European Languages, other Languages	PB – PM	2.55
Literary Studies & Film Studies	PN – PZ	2.55 – 2.59, 2M.54 – 2M.59, 2.62 – 2.71, 2M.62 – 2M.65, 2M.72 – 2M.71
Military Science	U	2M.71 – 2M.67
Naval Science	V	2M.67
Bibliography: Historical and General and Subject	Z	2M.67 – 2M.66

### [Humanities Books] Folio & Outsize

Classmark	Room(s)
FOL A 1 – ZA 9999	2M.14 – 2M.20
OUTSIZE A 1 – ZA 9999	2M.13
Atlases	2M.12

### [Humanities journals]

A – J	G.54 – G.59
J – Sp	GM.54 – GM.59
Sp – Z	G.66 – G.67
Modern Greek	G.67

### Music, Film & Multimedia

	Room(s)
Scores	GM.66 – GM.70
Outsize scores	G.68
Unbound scores	G.70
Multimedia	G.68 – G.70
Multimedia players	GM.66 – GM.70

Short loan books are in rooms G.49 – G51

[Humanities Short-loan]  
[Science Short-loan]  
[Law Short-loan]



- Humanities, Law & Science books for 24 hr rolling loan.
- Reservations that are awaiting collection are kept in the Short Loan area, room G.50

### [Humanities - Book Store]

A – DC	-1.12 – -1.14
DC – JV	-1.50 – -1.51
L – ZA	-1.55 – -1.59
Folio & Reference	-1.59

[Science - Book Store] -1.12

[Law - Book Store] -1.16

ABCDEFGHIJKLMNOPQRSTUVWXYZ

### [Science books]

Subject	Classmark	Room(s)
Science (General)	Q	2.35
Mathematics	QA	2.35 – 2.38, 2M.35 – 2M.37
Computer Science	QA 76 – QA 9999	2.35 – 2.38, 2M.35 – 2M.37
Astronomy	QB	2M.37
Physics	QC	2M.35 – 2M.37 2.40 – 2.42
Agriculture	S	2M.39
Technology (General)	T	2M.39 – 2M.42
Mechanical Engineering	TJ	2M.39 – 2M.40
Electrical Engineering	TK – TX	2M.40 – 2M.42
Science reference		2.39

### [Science journals]

A – J	2.20 to 2.18 to 2.20
J	2M.19 to 2M.18 to 2M.20
J – P	2.26 to 2.27 to 2.25
P	2M.25 to 2M.27 to 2M.25

### [Law books]

Criminology	HV	1.26 – 1.24
International relations, International Law	JX – JZ	1.25 – 1.27
Law	K – KP	1.27 – 1.38
Medical Ethics	KR – KZ	1M.35 – 1M.37
Quick reference A – K		1.42
Quick reference L – Z		1M.42
Law reference		1.42

### [Law books] Folio & Pamphlets

FOL HV – KZA, Graveson offprints, PAMPH. BOX		1.31
----------------------------------------------	--	------

### [Law journals]

A – O	1.44 to 1.43 to 1.51 to 1.44
P – Z	1M.43 to 1M.51 to 1M.44

### [Law journals] Folio

A – O	1.40 to 1.41 to 1.39
P – Z	1M.39 to 1M.41 to 1M.39

# Classics – Part 1/2

**Key classmarks for this area of study on floors 1 and 1M are:**

- **DE** - for the history of the Greco-Roman world
- **DF** - for the history of Ancient Greece
- **DG** - for the history of Ancient Italy

**Key classmarks for this area of study on floors 2 and 2M are:**

- **PA** - for Greek language and literature and Roman language and literature

# Classics – Part 2/2

## External Libraries of interest are

- Institute of Classical Studies Library / Joint Library of the Hellenic and Roman Societies

- **Postgraduates** are entitled to free membership of the ICS Library for reference use. If you wish to borrow, you will need to join the Hellenic Society or the Roman Society for an annual subscription. The student rate is £25/year.
- **Undergraduates** will need to join either the Hellenic or the Roman Society at a student rate of £25/year to obtain reference and borrowing rights. You will, however, be allowed visiting rights free of charge for two separate days before you will be asked to join.

- Warburg Institute Library

Please check with them for access restrictions before visiting.



# Comparative literature - Part 1/2

**Key classmarks for this area of study are on Floors 2 and 2M:**

- PA5000-5660 - Byzantine and modern Greek literature
- PQ1-3999 - French literature
- PQ6001-6726 - Spanish literature
- PQ7081-8560 - Spanish American literature
- PQ9000-9326 - Portuguese literature
- PQ9500-9796 - Brazilian literature
- PQ9900-9948 - Portuguese African literature
- PR1-9680 - English literature
- PS1-3576 - American literature
- PT1-4897 – German literature
- PN45-57 - Theory
- PN80-99 - Criticism
- PN801-820 - Romance Literature
- PN821-840 - Germanic Literature
- PN851-884 - Comparative Literature
- PN1010-1525 - Poetry
- PN1600-3307 - Drama
- PN3311-3503 - Prose

# Comparative literature – Part 2/2

## External Libraries of interest are

- [Goethe Institut](#)
- [Institut Français](#)
- [Institute for the Study of the Americas Library](#)
- [Instituto Cervantes Library](#)

Please check with them for access restrictions before visiting.

# Culture, Media and Creative Industries

**Key classmarks for this area of study are on Floors 2 and 2M:**

- Arts (General) - Room 2.44
- NX420-430 - Exhibitions
- NX440-632 - History of the Arts
- NX700-750 - Patronage
- NX760-770 - Administration
- NX798-820 - Centres and Facilities
- Museums (General) - Room 1.58
- AM111-160 - Museology
- AM200-501 - Collectors and Collecting
- Visual Arts - Room 2.45
- N61-72 - Theory
- Museums and Galleries - Room 2.45
- N4390-5098 - Exhibitions
- N5198-5299 - Private Collections
- N5300-7418 - History
- N8350-8356 - Art as a Profession
- N8600-8675 - Economics of Art
- N8700-9165 - Public Art

# Digital Humanities

**Key classmarks for this area of study are on the Floors 2 and 2M:**

- QA76.9.A8 - Applications of computers in the humanities
- QA76.9.A25 - Access control, computer security
- QA76.9.A73 - Architecture, computer
- QA76.9.A96 - Automatic theorem proving
- QA76.9.C65 - Computer simulation
- QA76.9.C66 - Computers and civilisation, social aspects
- QA76.9.D3 - Database management
- QA76.9.D35 - Data structures
- QA76.9.D5 - Distributed and parallel processing
- QA76.9.E94 - Evaluation of computer performance
- QA76.9.E96 - Expert systems
- QA76.9.H85 - Human computer interaction
- QA76.9.I58 - Interactive computer systems
- QA76.9.N38 - Natural language processing
- QA76.9.P75 - Psychological aspects
- QA76.9.S65 - Software engineering
- QA76.9.S88 - System design



# English

**Key classmarks for this area of study are on Floors 2 and 2M:**

Books on English can be found between PR1 and PR9680.

Classmarks of specific interest are:

- PR1-56 English Literary History and Criticism
- PR111-116 Women Authors
- PR500-614 Poetry
- PR908 Diaries
- PR951-981 Folk literature

# Film Studies

**Key classmarks for this area of study are on Floor 2:**

For books about Film Studies, they are on Floor 2 in rooms **2.56, 2.57, 2.58** and **2.59**.

Key classmarks for this area are:

- PN1993 - for film guides such as Halliwell's or Time Out Film Guide
- PN1993.5 - National cinema movements and guides to film from particular countries
- PN1994/1995 - film theory and criticism.
- PN1995.9 - specific genres and themes such as documentary, film noir, horror and sexuality.
- PN1997 - BFI guides on specific films
- PN1998 - criticism and commentaries on the films and careers of key directors.

Multimedia materials and players are on the Ground (G) and the Ground Mezzanine (GM) floors.

We also have [Film and video streaming services](#).

# French

**Key classmarks for this area of study on floors 1 and 1M are:**

- DC1-947 - French history

**Key classmarks for this area of study on floors 2 and 2M are:**

- JN2301-3007 - French politics
- PC2001-3761 - French language
- PN1993 - French film
- PQ1-3999 - French literature

## **External Libraries of interest are**

- [Institut Français](#)

Please check with them for access restrictions before visiting.

# German

**Key classmarks for this area of study on floors 1 and 1M are:**

- DD1-905 - German history

**Key classmarks for this area of study on floors 2 and 2M are:**

- JN3201-4980 - German politics
- PF3001-5999 - German language
- PN1993 - German film
- PT1-4897 - German literature

## **External Libraries of interest are**

- [Goethe Institut](#)

Please check with them for access restrictions before visiting.



# History

**Key classmarks for this area of study on floors 1 and 1M are:**

- BL-BX- for Religion and Religious History
- D - for European and World History

**Key classmarks for this area of study on floors 2 and 2M are:**

- E & F - for the History of the Americas
- HC-HD - for Economic History
- JC & JN - for Political Theory and Institutions

# Law

<b>[Law books]</b>		
<b>Criminology</b>	HV	1.26 – 1.24
<b>International relations, International Law</b>	JX – JZ	1.25 – 1.27
<b>Law</b>	K – KP	1.27 – 1.38
<b>Medical Ethics</b>	KR – KZ	1M.35 – 1M.37
Quick reference A – K		1.42
Quick reference L – Z		1M.42
Law reference		1.42
<b>[Law books] Folio &amp; Pamphlets</b>		
FOL. HV – KZA, Graveson offprints, PAMPH. BOX		1.31
<b>[Law journals]</b>		
A – O	1.44 to 1.43 to 1.51 to 1.44	
P – Z	1M.43 to 1M.51 to 1M.44	
<b>[Law journals] Folio</b>		
A – O	1.40 to 1.41 to 1.39	
P – Z	1M.39 to 1M.41 to 1M.39	

Most Law books and journals are located on Floors 1 and 1M.

To know more about where books for a specific subject are located, see the Browsing Guide table to the left.

# Music

**Key classmarks for this area of study are on Floor 2:**

For books about music, they are on Floor 2 in rooms 2.45-2.46.

- ML - which covers literature on music
- MT - which covers music instruction and study

**Music scores, multimedia materials, as well as music and BluRay players are located on the Ground (G) and Ground Mezzanine (GM) floors.**

**For music scores:**

- M1-3 - Collections and Manuscripts
- M5-1490 - Instrumental Music, begins with solo instruments and finishes with large orchestral groups
- M1497-1998 - Secular Vocal Music
- M1999-2199 - Sacred Vocal Music

**External Libraries of interest are**

- [Barbican Music Library](#)
- [Westminster Music Library](#)

Please check with them for access restrictions before visiting.

# Music Scores, Film and Multimedia

Music, Film & Multimedia	Room(s)
Scores	GM.66 – GM.70
Outsize scores	G.68
Unbound scores	G.70
Multimedia	G.68 – G.70
Multimedia players	GM.66 – GM.70

Music scores, multimedia materials, as well as music and BluRay players are located on the Ground (G) and Ground Mezzanine (GM) floors.

To know more about where books for a specific subject are located, see the Browsing Guide table to the left.



# Philosophy

**Key classmarks for this area of study are on Floors 1 and 1M:**

- B1-5739- Philosophy (General)
- BC1-199 - Logic
- BC200- Language and Philosophy
- BD10-701- Speculative Psychology
- BF1-990- Psychology
- BH1-301- Aesthetics
- BJ1-1725 - Ethics

# Political Economy

**Key classmarks for this area of study are on Floors 2 and 2M:**

- H - Social Sciences
- HA - Statistics
- HF - Political economy
- HG - Economics
- HV - Social Policy and Public Welfare. Crime
- J - Political Science
- JC - Political Theory
- JX - International Law
- JZ - International Relations

# Science

<b>[Science books]</b>		
<b>Subject</b>	<b>Classmark</b>	<b>Room(s)</b>
Science (General)	Q	2.35
Mathematics	QA	2.35 – 2.38, 2M.35 – 2M.37
Computer Science	QA 76 – QA 9999	2.35 – 2.38, 2M.35 – 2M.37
Astronomy	QB	2M.37
Physics	QC	2M.35 – 2M.37 2.40 – 2.42
Agriculture	S	2M.39
Technology (General)	T	2M.39 – 2M.42
Mechanical Engineering	TJ	2M.39 – 2M.40
Electrical Engineering	TK – TX	2M.40 – 2M.42
Science reference		2.39
<b>[Science journals]</b>		
A – J		2.20 to 2.18 to 2.20
J		2M.19 to 2M.18 to 2M.20
J – P		2.25 to 2.27 to 2.25
P		2M.25 to 2M.27 to 2M.25

Most science books and journals are on Floors 2 and 2M.

To know more about where books for a specific subject are located, see the Browsing Guide table to the left.

# Spanish, Portuguese and Latin American Studies

**Key classmarks for this area of study on floors 1 and 1M are:**

- DP1-402 - Spanish history
- DP501-900.22 - Portuguese history

**Key classmarks for this area of study on floors 2 and 2M are:**

- F1201-3799 - Latin American history
- JN8101-8399 - Spanish politics
- JN8423-8661 - Portuguese politics
- JL1200-2499 - Latin American politics
- PC4001-4977 - Spanish language
- PC5001-5498 - Portuguese language
- PQ6001-6726 - Spanish literature
- PQ7081-8560 - Spanish American literature
- PQ9000-9326 - Portuguese literature
- PQ9500-9796 - Brazilian literature



# Theology and Religious Studies

**Key classmarks for this area of study are on the Floors 2 and 2M:**

- BL1-2790- Religions, mythology, rationalism
- BM1-990- Judaism
- BP 1-605- Islam, Bahaism, theosophy
- BQ1-9800- Buddhism
- BR1-1725- Christianity
- BS1-2970- The Bible
- BT1-1480- Doctrinal Theology
- BV1-5099- Practical Theology
- BX1-9999 - Denominations and sects



## End of the tour

We hope you found this self-guided tour of the Maughan Library useful.

Follow us on [Instagram](#) or [Twitter](#) (search for “King’s libraries”) for all things library include new resources, jobs, and useful tips.

